



## **ELECTRIC WHEELBARROW**

### **SPB-800Li**



#### **ORIGINAL INSTRUCTIONS**



**IMPORTANT: PLEASE READ THIS MANUAL CAREFULLY BEFORE USING THE EQUIPMENT**



# 1 SAFETY

## 1.1 Intended use

The machine must only be used for its intended purpose. Any use other than what is outlined in this manual is considered misuse. To operate the machine properly, you must adhere to all safety regulations, assembly instructions, operating instructions, and maintenance guidelines described herein. All users must be familiar with this manual and understand its potential hazards.

The machine is used for the transportation of goods within the largest permissible load capacity.

**Sherpa Tools and its sales partners cannot be held liable for any direct or indirect damage caused by manipulation or misuse of the machine and or its parts.**

WARNING	
	<ul style="list-style-type: none"><li>• <b>The removal or modification of safety components may result in equipment damage and significant injury. This poses the highest risk of injury!</b></li></ul>

### Ambient conditions

The machine should be operated:

- **Humidity:** 0% to 70%
- **Temperature:** 0°C to 40°C (32°F to 104°F)

The machine, particularly the battery, must not be exposed to temperatures exceeding 40°C.

### Prohibited use:

- Operating the machine outside the technical limits described in this manual is prohibited.
- Operating the machine without protective devices is prohibited.
- Any manipulation of the machine and its parts is prohibited.

## **1.2 Safety instructions**

- Read Safety instructions fully before assembly or use.
- Replace missing or illegible security stickers immediately.
- To avoid malfunctions, machine defects, and injuries, adhere to the following instructions:
- Use the machine only in adequate lighting conditions for visibility and safe operation.
- Do not operate the machine when exhausted, distracted, or under the influence of alcohol or drugs.
- Exercise caution in slippery conditions; wear non-slip footwear.
- Only trained competent personnel should operate the barrow.
- Always use both hands while operating.
- Keep the instruction manual with the machine and provide it to any new or unfamiliar operators.
- Conduct a safety check on the machine before each use.
- Take care when operating near pools, ponds, or any bodies of water.
- Do not operate the machine in rain or damp areas.
- Unplug the battery before changing settings or performing maintenance.
- Remove battery from barrow for prolonged storage
- Keep barrow undercover during storage and protect from adverse weather conditions.

### **CHARGER INSTRUCTIONS:**

- The charger is designed solely for charging the battery of this machine; charging other batteries is not permitted.
- Never use the charger in damp environments.
- Disconnect the cable from the mains supply by pulling the plug, not the cable, to avoid damage.
- Do not use the charger if the cord, plug, or appliance is damaged. Avoid using it near heat sources.
- Do not use an extension cord to supply power to the charging station.
- Keep metal objects away from the charger's contacts.
- Do not open or attempt to service the charger. Contact a specialist if required.
- Only recharge your battery with the original charger; using other chargers may cause defects or pose a potential fire hazard.

## BATTERY:

### Storage

- Remove batteries from Barrow when not in use.
- Store batteries in a dry place at room temperature.
- Keep batteries away from direct sunlight, high humidity, and flammable materials.
- Don't store batteries in places where they could be crushed, punctured, or immersed in water.
- **Fire Hazard:** Never charge batteries near acids or flammable materials.
- Charge the battery only at temperatures between 0°C and 40°C. Allow to cool after charging.
- **Explosive Risk:** Protect the battery from heat fire and water.
- **Short Circuit Risk:** Batteries must be packaged and taped securely for disposal, transport, or storage.
- Never open the battery.

### 1.3 Remaining risk factors

Despite following intended use, certain residual risks remain. Due to the design and construction of the machine, hazardous situations may arise. Your common sense and technical training are critical for safe operation.

## 2 ASSEMBLY

Check the product contents immediately upon receipt for any transport damage or missing parts. Claims for transport damage or missing parts must be made immediately after unpacking before the machine is put into operation. Late claims cannot be accepted.

NOTICE	
	Do not fully tighten all screws until assembly is complete.

## 2.2 Assembly-steps

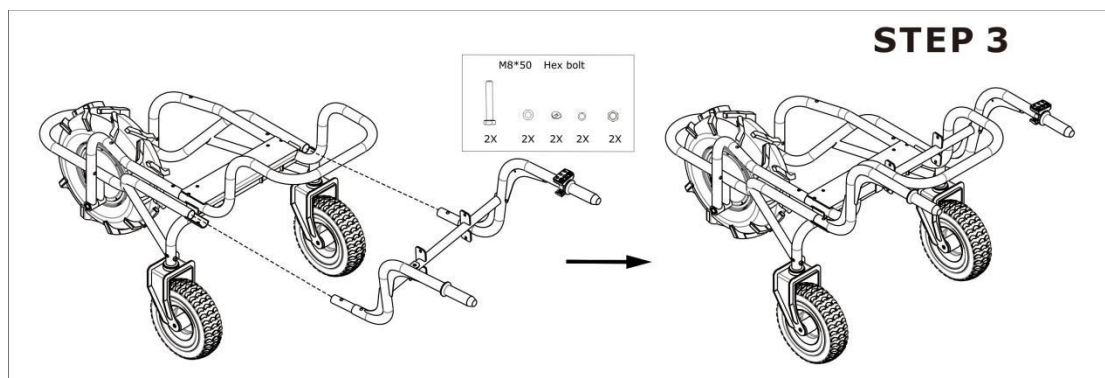
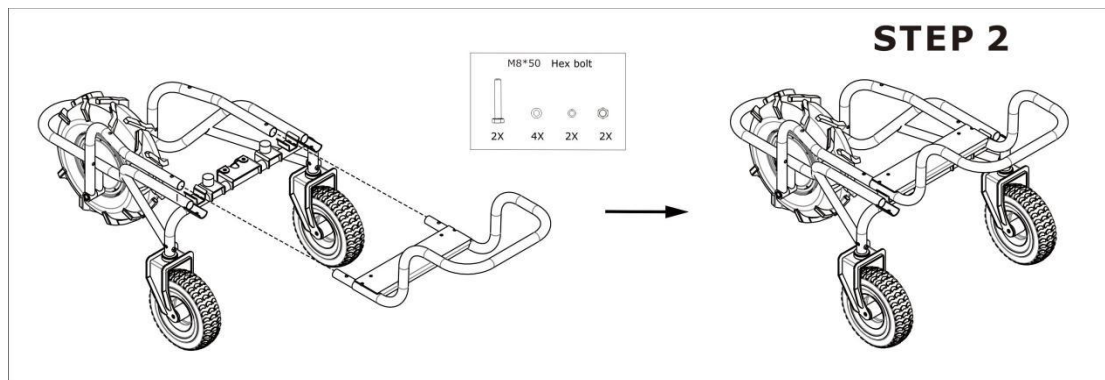
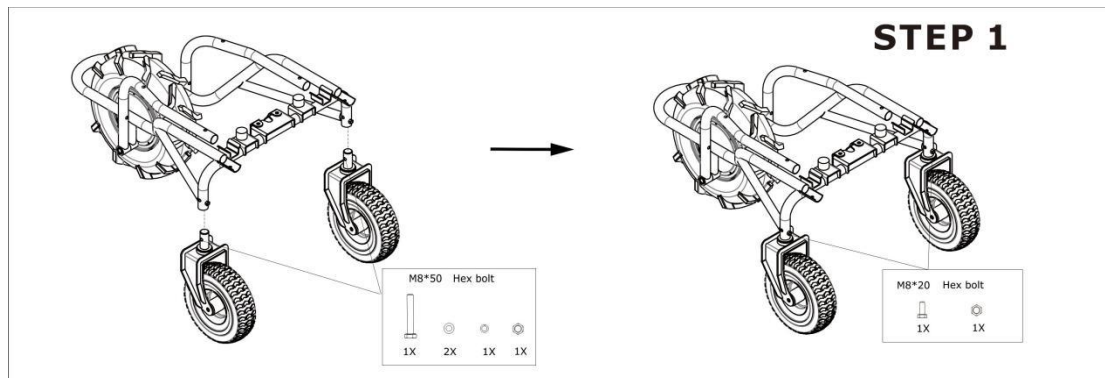

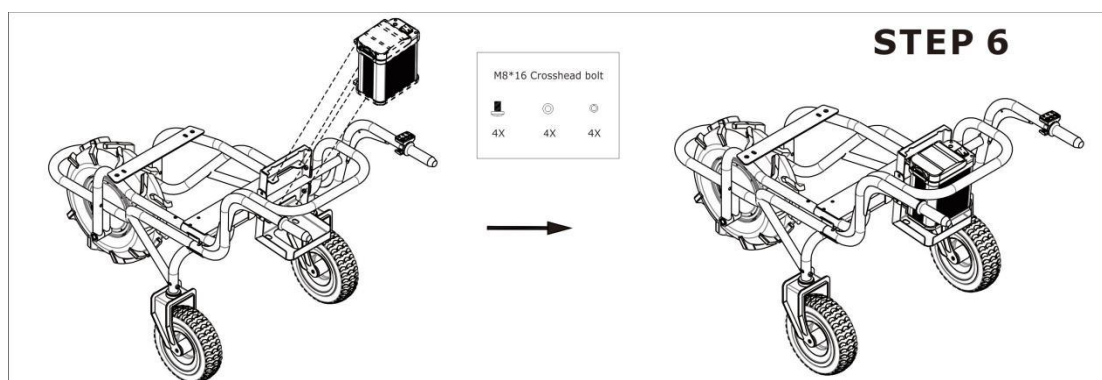
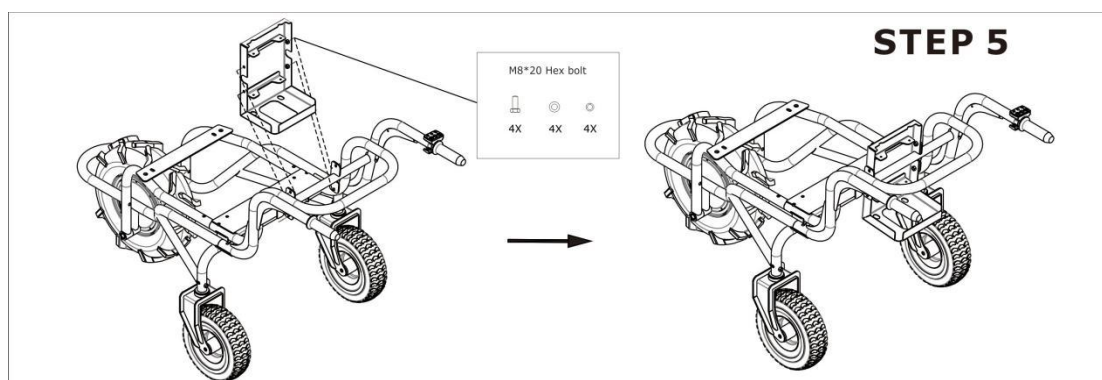
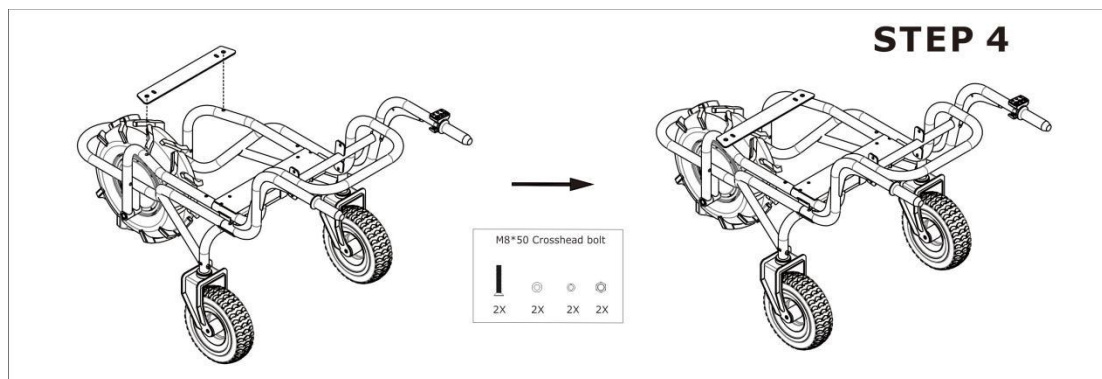

**STEP 7**

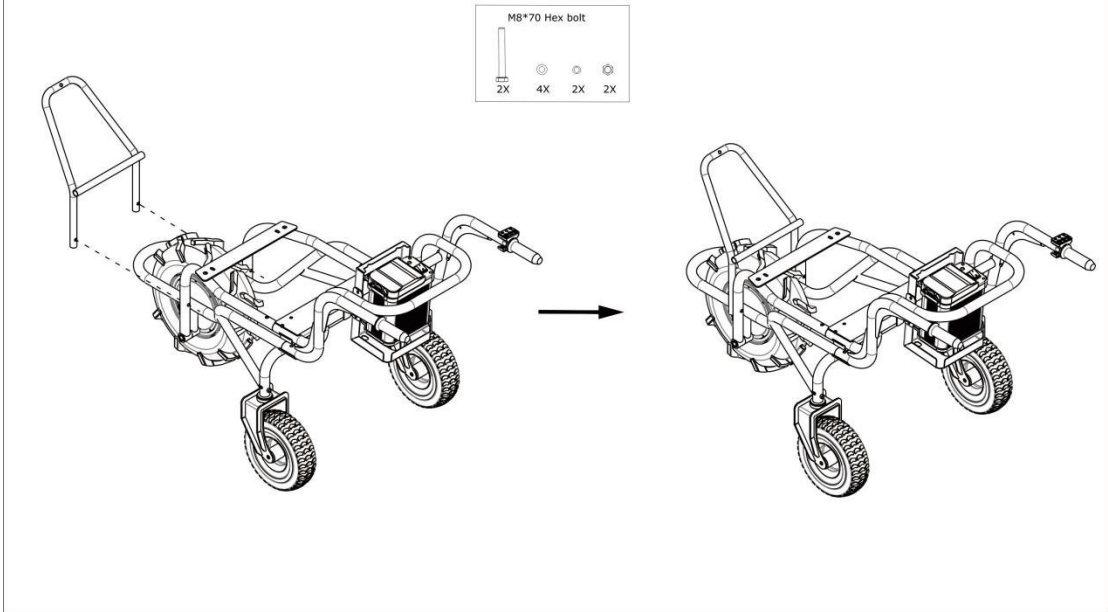

**STEP 8**

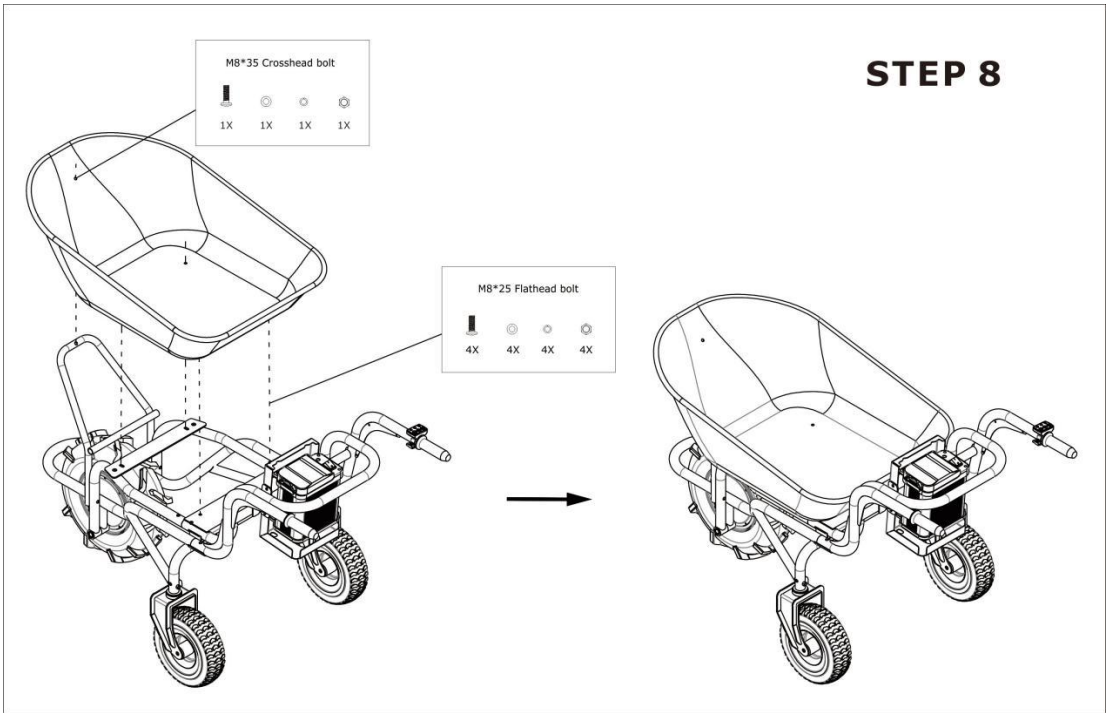

## 2.2 Assembly-steps for cable

- Connecting the control lever cable

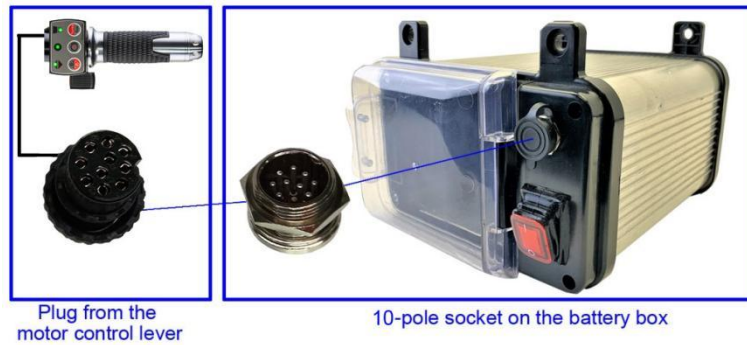

- Connecting the motor cable

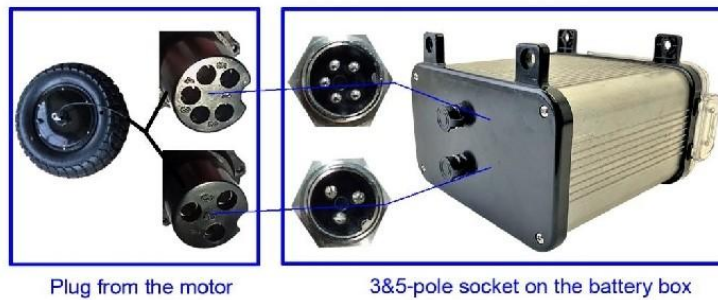

**Warning: Only nut #1 may be turned to fasten or unfasten the plug; nut #2 must not be turned except for professional repair.**





### 3 OPERATION

The machine must be in perfect condition before use. Inspect the machine visually each time it is to be used. Check the safety equipment, electrical controls, cables, and connections for damage and proper tightness. Replace any damaged parts before operating.

#### 3.1 Operation instructions

<b>WARNING</b>	
	<b>Unplug the battery before all maintenance and adjustments!</b>

<b>NOTICE</b>	
	<ul style="list-style-type: none"><li>• <b>Never remove the battery while the machine is running.</b></li><li>• <b>If the machine will be stationary for an extended period, switch off the power.</b></li><li>• <b>Use the electric motor only with a sufficiently charged battery.</b></li></ul>

## 3.2 Operation

### 3.2.1 Start Power drive support

	<ul style="list-style-type: none"> <li>Press the button on the battery box to "1: =ON". Lights #L4 (green), #L3 (green), and #L1 (green) will be ON; lights #L2 and #L5 will be OFF.</li> </ul>
	<ul style="list-style-type: none"> <li>Press the throttle lever #1 to move the wheelbarrow forward.</li> <li>Press button #2; light #L4 will be ON, and light #L5 will be ON. Press throttle lever #1 to move backwards.</li> <li>Press button #3 to activate EBS; light #L3 will turn red. The wheelbarrow will not move when throttle lever #1 is pressed. Press button #3 again to deactivate EBS.</li> <li>Press button #4 to activate a high-power mode; light #L2 will be ON. Press button #4 again to return to Eco mode, which extends working time.</li> </ul>

**Electronic Brake System:** This wheelbarrow is equipped with electronic brake EBS/BAS

<b>BAS - Brake Assistance System</b>	<p>The BAS Prevents freewheeling and will work only when:</p> <ul style="list-style-type: none"> <li>The Power button on the battery box is "1: =ON".</li> <li>Thumb switch #1 is at its original position, with no acceleration.</li> </ul>
<b>EBS - Electronic Brake System</b>	<p>The EBS Parking Brake will work only when:</p> <ul style="list-style-type: none"> <li>The Power button on the battery box is "1: =ON".</li> <li>Brake switch button #3 is activated L3 =RED</li> </ul>

**Notice:**

- When EBS is ON, the wheelbarrow will be stopped completely. Even if the thumb switch is pressed, the wheelbarrow will not move.
- When BAS is on, the wheelbarrow will not freewheel and be difficult to push on the flat ground, however, if stopped on a downward slope, it may move slowly depending on load.
- BAS will only consume a small amount of energy from the battery and is recommended that BAS be used most of the time.
- EBS provide strong breaking force, ideal for use on steep slopes or dumping loads, however, it will consume more energy from the battery.
- The brake systems options above will provide convenience and safety while the wheelbarrow is on the slopes or dumping heavy loads.

**3.3 Charger**

The charger is integrated with the battery system (#7).

**Charging the battery:**

- Connect the charger to the power supply (AC outlet) 230 V / 50 Hz and the charger plug.
- Charge the battery. Once fully charged (indicated on the charger), the charger can be removed.

**LED- indication: The voltage display on the battery box indicates the status of the battery.**

Voltage display shows 42 V	Battery capacity 100%
Voltage display shows 35 V	Battery capacity ~50%
Voltage display shows < 30 V	Recommended to charge the battery



- #1 Voltage display switch
- #2 Voltage display
- #3 Recharge port

## 4 MAINTENANCE

<b>ATTENTION</b>	
	<p><b>Unplug the battery before all maintenance and adjustments to prevent unintentional activation of the machine.</b></p> <p><b>The machine requires minimal maintenance. If malfunctions occur, it must be serviced by trained personnel only.</b></p>

Regularly check the condition of the security stickers. Ensure they are always visible.

Regularly check the condition of the machine.

After each work shift, check cables for tightness and damage

Monthly: Lubricate/grease moving parts, and check tyre pressure.

Store the Barrow in a covered, dry location after each use.

### 4.1 Cleaning

<b>NOTICE</b>
<ul style="list-style-type: none"><li>• <b>Certain cleaning solutions may damage metal surfaces; avoid scrubbing agents.</b></li><li>• <b>Clean the machine surface with a damp cloth after each use.</b></li><li>• <b>Never use a high-pressure cleaner.</b></li><li>• <b>Clean outer parts with a damp sponge.</b></li><li>• <b>Do not clean electronic parts with water; use a brush to remove deposits.</b></li></ul>

### 4.2 Storage

- Carefully Clean all components thoroughly before storage. (See warnings)
- Store Battery components separately in a dry area at no less than 0 °C.
- Charge the battery fully before storing.

<b>NOTICE</b>
<p>During prolonged inactivity (at least one month), charge the battery.</p>

### 4.3 Battery Care

- Before using the battery, read all instructions and cautionary markings on (1) battery charger, (2) battery, and (3) product using the battery.
- Do not disassemble or tamper with the battery. It may result in a fire, excessive heat, or explosion.
- Avoid storing the battery in a container with other metal objects such as nails, coins, etc.
- Do not expose the battery to water or rain.
- Do not nail, cut, crush, throw, drop the battery cartridge, or hit against a hard object.
- Do not use a damaged battery.
- Do not allow chips, dust, or soil to stick into the terminals, holes, and grooves of the battery.



### 4.5 Disposal

Do not dispose of the machine or battery in residential waste. Contact local authorities for disposal options. When purchasing a replacement unit from your local dealer, they are obliged to exchange your old machine.

## 5 TROUBLESHOOTING

**BEFORE YOU START WORKING THE ELIMINATION OF DEFECTS, UNPLUG THE BATTERY.**

Problem	Possible cause	Solution
<b>No light or power</b>	The battery is not charged.	Recharge battery.
	Motor stuck.	Check motor.
	The power switch is damaged.	Check switch.
	Broken or loose cables.	Check cables.
<b>No charging of battery</b>	Loose cable.	Check the cable connection.

## 6 TECHNICAL

### 6.2 Technical data

SPB-800Li	
Rated voltage	40V DC
Battery capacity	6 Ah
Max. battery work time [h]	5 h
Motor power	280W
Motor rated speed	100 min <sup>-1</sup>
Speed	max. 6,0 km/h
Max. load capacity	260kg / 100l
Weight (net)	50 kg
Dimension	1550x760x890 mm
<b>Charger:</b>	
Input voltage	110~240 V / 50~60 Hz / AC
Power	66 W
Output	42 V
Charge time	3 h
Protection class II	III
<b>Battery:</b>	
Rated voltage	40 V
Battery capacity	6 Ah
Battery power	240Wh
Weight	1.8kg
Dimension	180x110x80mm

## **7      WARRANTY**

This product is warranted for 12 months following legal regulations, effective from the date of purchase by the first user.

This warranty covers all material or production failures. It does not include defects from normal wear and tear, parts such as bearings, cables, brake pads, clutch discs, or wheels, damage or defects resulting from abuse, accidents or alterations, natural fading of painted or plated surfaces, sheet peeling, and other natural deterioration.

Any damage that occurs from the use of non-genuine Sherpa Tools parts will not be covered. We reserve the right to reject any claim where the purchase cannot be verified or when the product was not maintained properly.

Expenses incidental to the warranty claim that are not covered.

- Compensation for loss of time, commercial loss or rental costs of a substitute product.
- Costs incurred for transportation to and from the dealership.

Any damage resulting from operating methods other than those indicated in the owner's manual will not be covered.

Your purchase receipt must be kept as proof of date of purchase. Your un-dismantled barrow must be returned to your dealer in an acceptably clean state, accompanied by your proof of purchase.

**Date Of Purchase:** .....

# 8 SPARE PARTS

The installation of parts other than the original parts voids the warranty!

When you place a spare parts order, please always take note of the machine type, spare part number and part name. We recommend copying the spare parts diagram below and marking the spare parts you need.

Please contact Sherpa Tools at 01522 283020 or [info@sherpatools.co.uk](mailto:info@sherpatools.co.uk) if a parts order is required.

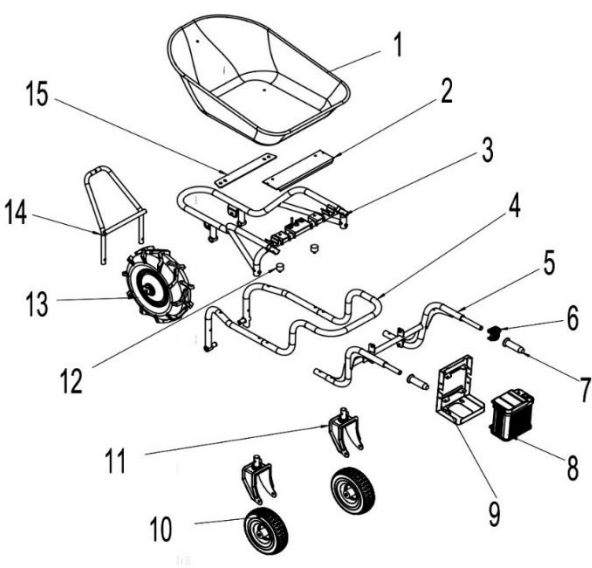

Pos	Parts name	Qty
1	tray	1
2	back reinforced rib	1
3	below main frame	1
4	upper dumper frame	1
5	handle	1
6	speed control lever	2
7	handle cap	1
8	battery box assy	1
9	battery box support	1
10	wheel	1
11	universal wheel holder	2
12	shock absorber	2
13	motor assy	1
14	front tray support	1
15	front reinforced rib	1

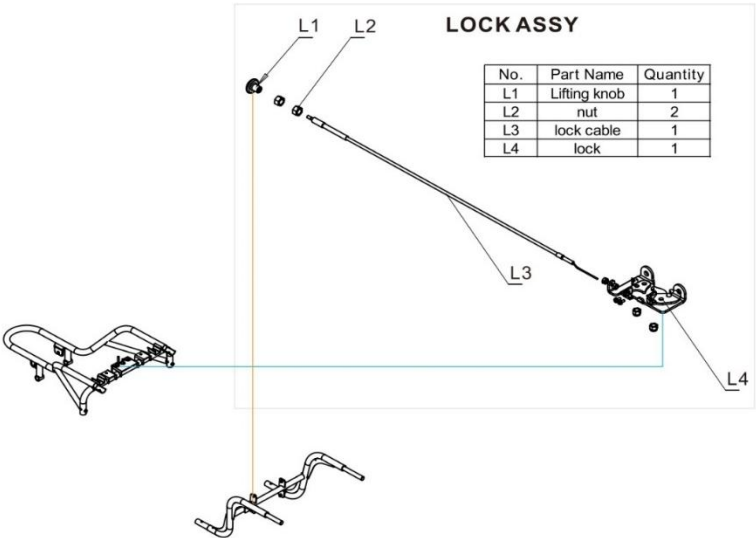

No.	Part Name	Quantity
L1	Lifting knob	1
L2	nut	2
L3	lock cable	1
L4	lock	1



## 9 EC-DECLARATION OF CONFORMITY

EC DECLARATION OF CONFORMITY	
<b>We declare</b>	Sherpa Tools, Magic House, Station Rd, North Hykeham, Lincoln LN6 9AL
The following machine complies with the appropriate basic health & safety requirements of the EC directive based on its design and type, as brought into circulation by us.	
In case of alteration of the SPB-800Li, without consent from us, this declaration will no longer be a valid document.	
<b>Product:</b>	Electric Power Barrow
<b>Product Code:</b>	SPB-800Li
<b>Voltage (V):</b>	40V
<b>Measured Sound Power Level:</b>	
<b>Guaranteed Sound Power Level:</b>	
<b>Notified Body:</b>	
<b>Applicable EC Directives</b>	
<b>Applicable Harmonised Standards</b>	
<b>Authorised Signature/Date/Place</b>	
<b>Signatory Title</b>	
<b>Name &amp; Address of person authorised to compile technical files</b>	Sherpa Tools, Magic House, Station Rd, North Hykeham, Lincoln LN6 9AL